

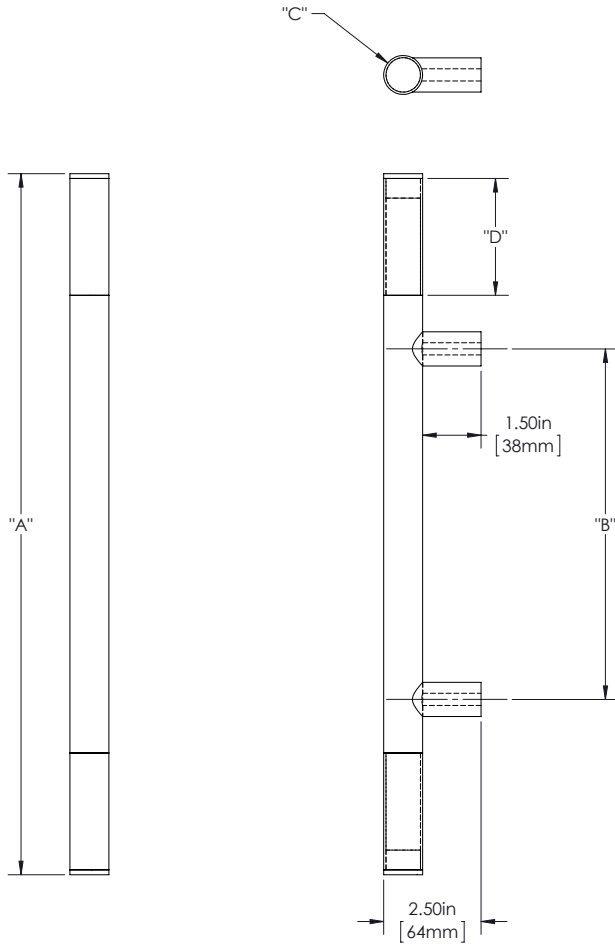

SPECIFICATIONS



Product Description: 1" Solid Round Wood Grip with Sleeves and Straight Round Mounts in Brass

Material	Acrylic	Aluminum	Brass	Stainless Steel	Wood
Grip					✓
Mount(s)			✓		

Overall Length "A"	Center To Center "B"	Overall Diameter "C"	Sleeve Length "D"
12"(305mm)	7"(178mm)	1"(25mm)	1 1/2"(38mm)
24"(610mm)	15"(381mm)	1"(25mm)	3"(76mm)
36"(914mm)	27"(686mm)	1"(25mm)	3"(76mm)

Finishes	Cherry	Bubinga	Ipe	Jatoba	Mahogany	White Oak	Teak	Black Walnut
Grip	✓	✓	✓	✓	✓	✓	✓	✓

Finishes	Aged Brass	Antique Brass	Polished Brass	Satin Brass	Oil Rubbed Bronze	Polished Chrome	Satin Chrome	Polished Nickel	Satin Nickel	Brushed Stainless	Polished Stainless	Powder Coated	Lithonia
Mount(s)	✓	✓	✓	✓	✓	✓	✓	✓	✓			✓	✓

Custom sizes & finishes available upon request

Dimensions are approximate and provided for reference purposes only