

Vero Handrinse basin # 0702250000

< 9 7/8" Inch >

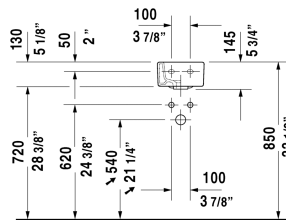
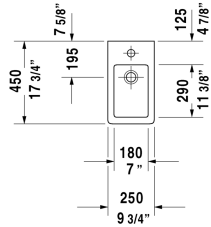

Handrinse basin	Dimension	Weight	Order number
with overflow, with faucet deck, underside fully glazed, wall-mounted, hardware included, cUPC® listed*, 9 7/8" Inch			
Colors			
00 White			
Variant			
●	9 7/8" x 17 3/4" Inch	19.6 lb	0702250000
Infobox			
* Complies with following standards: ASME A112.19.2/CSA B45.1			
Sanitary ceramics with the special WonderGliss surface finish will remain clean and attractive-looking for a long time to come. When ordering WonderGliss please add a "1" as eleventh digit to the model number.			

All drawings contain the necessary measurements which are subject to standard tolerances. They are stated in inch & mm and are non-binding. Exact measurements, in particular for customized installation scenarios, can only be taken from the finished ceramic piece.